

1385-1399 Ninth St.



FOR LEASE

RARE WEST BERKELEY LIGHT INDUSTRIAL SPACES

LOCATION

1385 - 1399
Ninth Street

OFFERED AT

1385 - \$1.75/SF
1375 - \$2.00/SF
1399 - \$2.00/SF

PROPERTY HIGHLIGHTS

- Small Light Industrial spaces
- High ceilings
- Skylights
- Dock-high access
- Restrooms
- Small offices
- Kitchenette
- Gilman District near Whole Foods, Philz Coffee, Farm Burger, REI, Walgreens

SIZE

1385 - ±3,950 SF
1375 - ±1,755 SF
1399 - ±1,790 SF

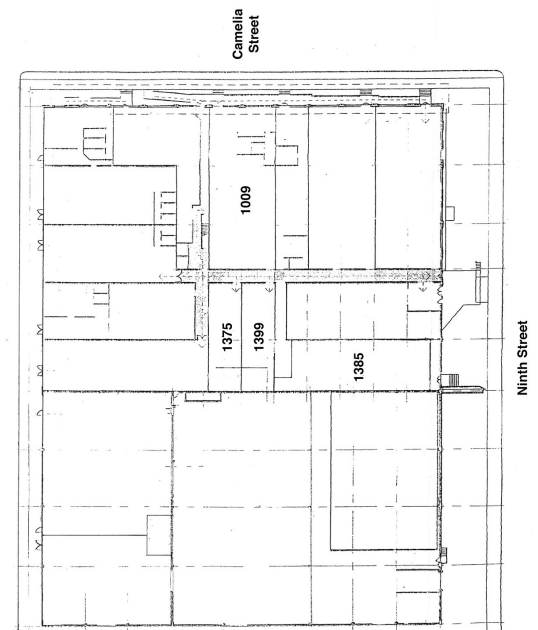

**NORHEIM
& YOST**

732 Addison Street
Suite "C"
Berkeley, CA 94710

Steve Smith

BRE# 01330154

ss@noryost.com

510-527-3400 x12

All information furnished herein was provided by sources deemed reliable, but no representation is made or implied as to the accuracy thereof.

1385 – 1399 Ninth Street

