



2043 San Pablo Ave.

FOR SUBLEASE

RARE WEST BERKELEY RETAIL

LOCATION

2043 San Pablo Ave.
Between Addison St.
and University Ave.

OFFERED AT

\$1.75 /sq. ft. IG

PROPERTY HIGHLIGHTS:

- Large open floor-plan with high ceilings and skylights
- Current build-out for event space
- Brand new facade with sliding glass doors
- Sandblasted brick walls
- New concrete floor at entry
- Lots of power, water, and gas
- Located in West Berkeley's "Poet's Corner" neighborhood between the Design Loop and International Marketplace Districts.
- New restrooms
- Great meeting space
- Nearby Highway I-80 and UC Berkeley Campus
- Nearby Lanesplitter Pizza, Highwire Coffee Roasters, Acme Bar, La Marcha Tapas Bar, and more

SIZE

3,400 sq. ft.

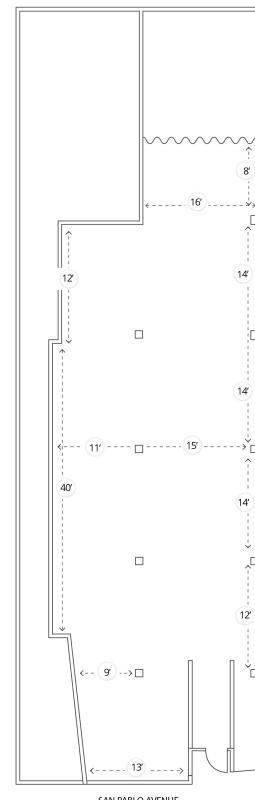

**NORHEIM
& YOST**

732 Addison Street
Suite "C"
Berkeley, CA 94710

Steve Smith

BRE# 01330154
ss@noryost.com
510-527-3400 x12

John Norheim

BRE # 00770171
jn@noryost.com
510-527-3400 x10

All information furnished herein was provided by sources deemed reliable, but no representation is made or implied as to the accuracy thereof.